

MIC-600 Fixed six-in-one gas detector

Online Toxic and Harmful Gas Detector

MIC600



The MIC-600 series fixed six-in-one gas detector is used for 24-hour continuous online monitoring and temperature and humidity measurement of various gas concentrations in the field, displaying the concentration and outputting standard signals on site, and remote data transmission. The 2.5-inch high-definition color screen displays the concentration in real time.

Advantage



Multi-alarm mode



Sensitive sensors



Data recovery



HD display



Endurance



Transmission mode

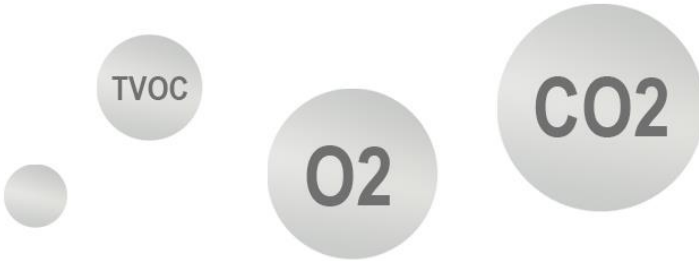

Composite gas detectors

(Optional simultaneous detection of 1 to 6 gases)

Diffusion Type

(Optional pipe type, flow type, pump type)

Three display interfaces



Single-Channel



Multi-Channel



Real-time Curve

Lightning protection

Overvoltage protection

Safe and Reliable

Anti-Reverse conectioint

Sound-light alarm(optional)

Anti-surge

Anti-static

LOT modules(optional)

Remote online alarm and data analysis from PC and mobile phone

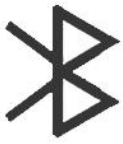

Bluetooth
transmission



LORA
transmission



4G
transmission



WiFi
transmission



GPS
location

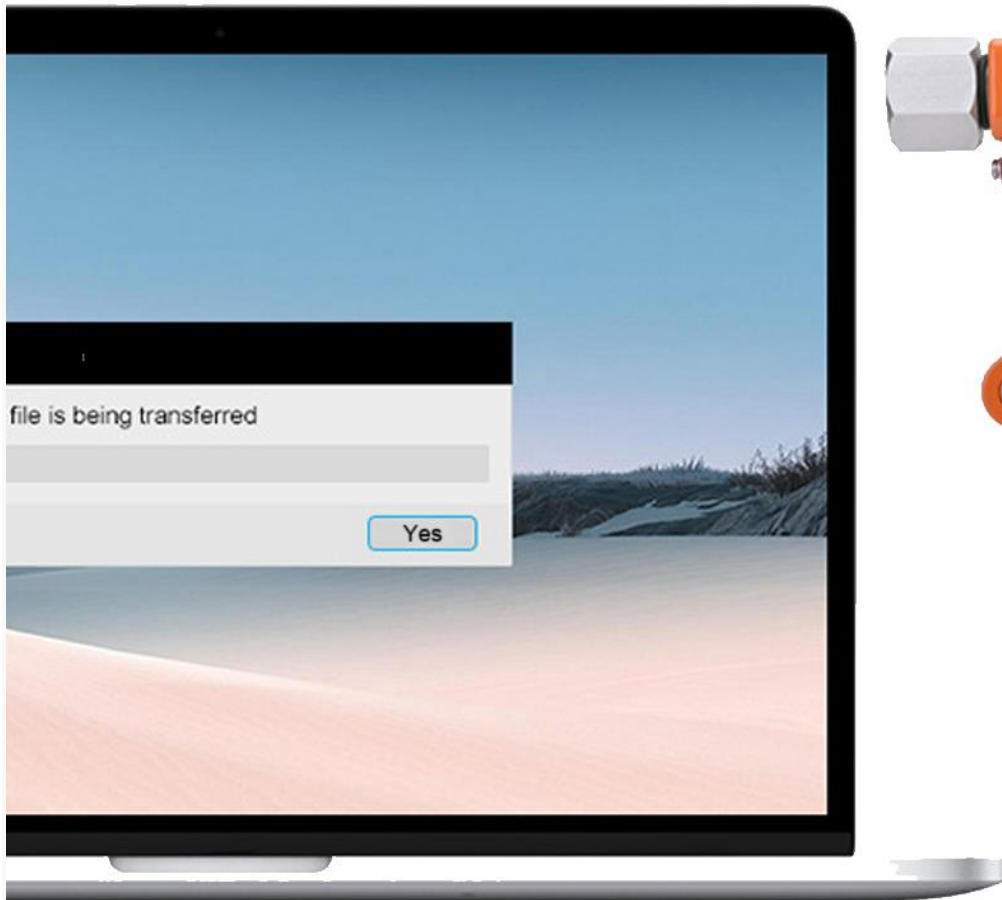

Multi-protection design

Die cast aluminum shell

IP66 protection grade



Explosion-proof grade
Exd IIC T6 Gb

Product structure



Parameter

Gas	CH4 (Methane)	Range	0-50000PPM; 0-100%LEL ; 0-100%Vol. other ranges can be customized
Size	210×170×85mm (LxHxW)	Weight	1.8 Kg
Installation method	Pipeline Type Wall Mounting Type	Display	2.5-inch high-definition color screen
Environment	Temperature: -40 °C ~ + 70 °C Humidity: ≤10 ~ 95% RH (regular)	Approvals	IP66; Exd II CT6
Accessories	Manual, qualification certificate, warranty card, outer packaging box		
Optional items	Alarms;Wireless Transmission;Pretreatment System; SD Card; Temperature and Humidity Measurement; Accessory for connection with computer for monitoring.		
Installation Type Accessories (Optional configuration)	Wall mounting bracket, mounting clips for fixation on the pipes (1/2", 3/4" pipe), stainless steel threaded welding seat or flange to be installed on the pipeline (it is necessary to mark the flange or pipe size, such as DN50, DN15 ...), rain cover, 24VDC or 220AC sampling pump (sampling distance is 10 m), vacuum pump (sampling distance is 40 m), 24V switching power supply, pressure reducing valve, flow meters		

Application

